

Notes

- 1. All Dims in mm Unless Otherwise Stated
- 2. Do Not Scale From This Drawing
- 3. Isolate All Dissimilar Materials With Barrier Tape
- 4. If in Doubt, ASK

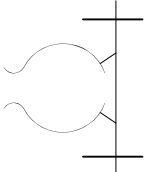

ALUMINIUM RIDGE FLASHING RIVETTED TO SLIDING RIDGE CLIP IN TWO PLACES WITH Ø4.8 mm x APPROX. 12 mm LONG ALUMINIUM BLIND SEALED TYPE RIVETS (WITH STAINLESS STEEL MANDREL), OR Ø5 mm x APPROX. 20 mm LONG ALUMINIUM 'BULB-TITE' NEOPRENE SEALED RIVETS (WITH ALUMINIUM MANDREL) RIVET TYPE TO BE DETERMINED BY GAUGE, LENGTH AND SHAPE OF FLASHING

KALZIP SHEET WITH END FOLDED UP

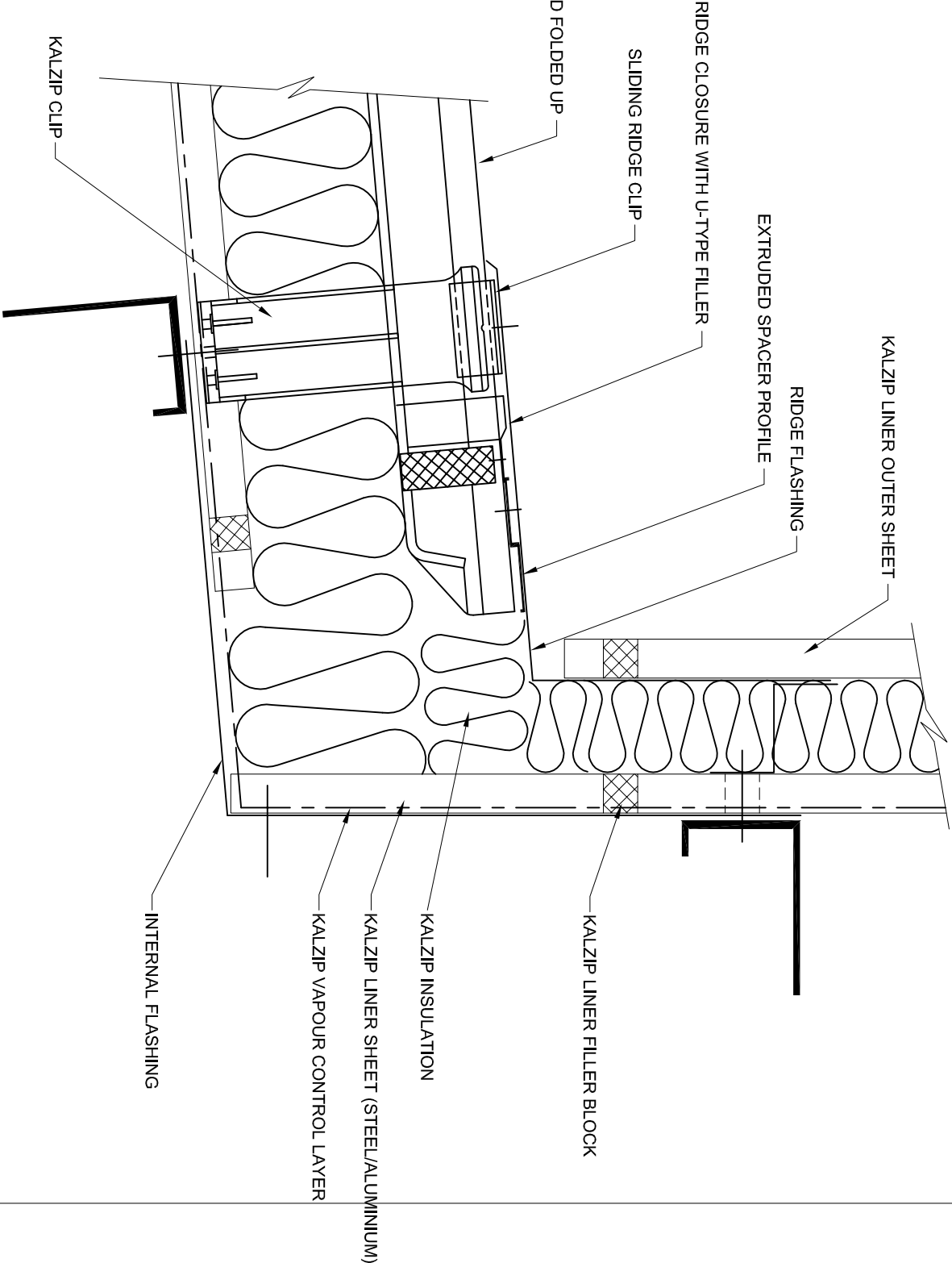

A Tata Steel Enterprise

Kalzip Ltd

Haydock Lane, Haydock, St. Helens
MERSEYSIDE, WA11 9TY

Tel: 01942 295 500
Fax: 01942 295 508

This drawing is copyright and is issued on the express condition that it is not to be copied or disclosed by or to any unauthorised person or firms without prior consent in writing from Kalzip.

Project: Double Skin Constructions				
Client: Kalzip Ltd.				
Title: Double Skin Sliding Mono-Ridge Abutment To Cladding				
Scale: 1:3	Date: 19/07/05	Drawn: KRT	Checked:	
Dwg No. KAL-0-DS-L-2-008			Rev: F	